

THE HOME MAG

MAY 2019

DISCOVER YOUR NEXT HOME IMPROVEMENT PROJECT® - WASHINGTON DC



CELEBRATING 24 YEARS! • WINDOWS • SIDING • DOORS • ROOFING

*Window
World*

4116 Walney Rd., #J
Chantilly, VA 20151

703-463-9973

210 Prosperity Drive
Winchester, VA 22602

540-409-4644

Maryland
Customers Call:

301-684-8003



SEE PAGE 5 FOR DETAILS
WindowWorldDC.com



BY JOHN BYRD
byrdmatx@gmail.com

LOWER LEVEL ENTERTAINMENT SUITE JUDGED WASHINGTON-AREA'S TOP BASEMENT REMODEL

Michael Nash design solution satisfies busy family's broad agenda

A sweeping family-entertainment suite introduced into an unfinished 5,100 square foot basement has won a "Contractor of the Year" (COTY) award for Michael Nash Kitchens and Homes.

The design solution, which integrates an open floorplan with several independent activity and gaming zones, was executed in 3 three-story Colonial-style residence in McLean. The project was recently named "best basement remodel" by the metro DC chapter of the National Association of the Remodeling Industry.

In acknowledging the honor, Michael Nash president and founder Sonny Nazemian pointed to the many ways the traditional American home is being radically changed by emerging owners requirements.

"Homeowners are increasingly focused on developing more personalized, long-term uses for their homes," Nazemian said. "A remodeler has to meet an ever-expanding array of needs--often arising within the same family. This may require more engineering and interior design skill than were typically available from a single source in years past. Our goal has always been to stay ahead of evolving needs--providing customers with an informed awareness of what is possible."



\$1000 OFF
Complete Remodeling Project
(Minimum \$25,000)
Present coupon at time of estimate. Not valid with any other offer. Offer expires 6/30/19.



For the Chantilly homeowners, the remodeling process began last year with a simple assessment of goals and priorities.

"The owners had purchased the house several years ago, but intentionally left the lower level unfinished because they didn't like the plans the builder had provided," Nazemian explains. "They had been stockpiling ideas for some time--looking for a remodeler who could help them articulate a vision that consisted of many complicated parts."

A home and garden feature about a Michael Nash project inspired the owners to visit to the remodeler's Lee Highway showroom; soon after, the research process began in earnest.

The core problem with re-doing the lower level, however, was structural: the two upper floors were partly supported by beams attached to solid steel vertical supports situated in the middle of square footage the owners wanted to convert into open floorplan.

To the make the build-out feasible, Nazemian and team insinuated a horizontal support beam balanced on new vertical supports flanked on either side of the nearly 800 square foot open area.

But with the structural resolved, attention now turned to the satellite of private-use components revolving around the lower-level's primary living space: a home theater, a wine cellar, an exercise studio and guest quarters with full bath--all to be integrated within an understated design scheme.



Gathering place.

With its Tuscan brown quartzite surfaces mounted on an espresso-hued mahogany base, the bar presents an eye-catching light-to-dark tonal contrast. The backsplash is ledgerstone; flooring is wood-grain porcelain tile in a herringbone pattern. The bar (which seats six) is equipped with a wine refrigerator, microwave and warming drawer.

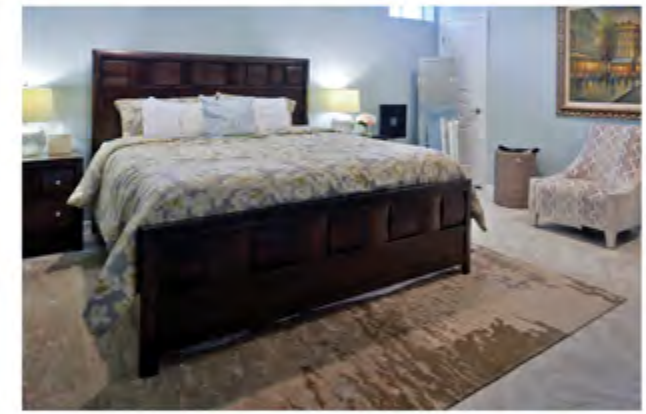
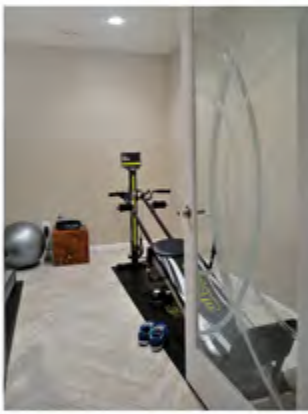

Exercise Area

An elliptical bike, bench press and other work-out equipment are available in the family's exercise room. A wall-sized mirror provides a visual means to track personal progress. The rubber floor absorbs sound.

Guest Bedroom

Situated away from the satellite of entertainment zones, the 18' x 15' guest accommodation offers an en suite full bath.

